

# Production Specifications

Catalog Number: **GT20**

**Ground Fault Circuit Interrupter Receptacle**  
20A,125V,60Hz.  
Back & Side Wire.  
Tamper-Resistant Receptacles.  
2-pole,3-wire, NEMA 5-20R,Self-Grounding.



**20A GFCI Outlet  
Self-Test**

**Color: White WH**

## General specifications

<b>Product Name</b>	<b>Catalog Number</b>
GFCI Receptacle	GT20
<b>UPC Code</b>	<b>Product Length</b>
8747003240201	1.56 in
<b>Product Height</b>	<b>Product Width</b>
4.07 in	1.71 in
<b>Product Weight</b>	<b>Certifications</b>
127g/0.280 lb	UL/CUL Listed NOM

## Material characteristics

- Material: Face, Thermoplastic; Body, Thermoplastic;
- 0.8mm thick high-precision phosphorus bronze;
- 1.2mm thick galvanized steel bracket;
- Silver alloy contacts with 30 silver layer thick;
- Coated PC board with Smart chip MCU to protect critical components from moisture;
- Environmental: Flammability UL-94 V2 Rating.



# Production Specifications

## Standard Certifications

- Meet UL®943 Class A GFCIs & UL®498 for receptacles;
- Complies to NEC®;
- UL®Listed E504391;
- CSA Certified;
- NOM Certified;
- Self-Test meets UL®943, 5th Ed./Csa 22.2 requirement.

## Electrical

- Trip Level: 4~6 mA;
- Trip Time: < 0.25 Seconds;
- Frequency: 60 Hz;
- Max Interruption: 10,000 A;
- Working Voltage: 102V~132V;
- Rating Voltage: 125V

## Environmental

- Operating Temperature: -35°C to 66°C (-30°F to 150 °F);
- Maximum Humidity: 95%.

## Applications

- Residential:
  - Bathrooms\Kitchens\Basements\Garages\Laundry rooms\Wet locations
- Social institution:
  - School class rooms\Laboratories\Restrooms and Kitchens
  - Airports\Commercial Offices\Shopping centers
  - Restaurants\Hotels\Public bathrooms
  - Public Areas receptacle which near wet or damp locations.

# Production Specifications

## Default Configuration

■ Device Type Receptacle	■ Type Self -Test	■ Circuit Interrupter Type GFCI
■ Amperage Rating 20A	■ Voltage Rating 125V	■ NEMA Configuration 5-20R
■ Features Tamper-Resistant	■ Contact Material Brass	■ Wiring Method Back & Side Wire,grounding
■ Torque Rating 16 lbf-inch	■ Number of Wires Three -wires	■ Number of Poles Two-poles

## GFCI Working Status



### Green light:

GFCI working properly;  
Cyclic testing every 15 minutes.



### Red light blinking:

GFCI Self-Testing;

### Red light On **ALERT !**

GFCI reached its service life and needs to be replaced.



### Led Off (No power):

GFCI tripped, press RESET button;  
Check the power circuit if can not reset.

## Colors:



White  
WH



Ivory  
IV



Alm ond  
AL



Grey  
GR



Black  
BK



Brown  
BR

# Production Specifications

## Dimensions

Standard plate

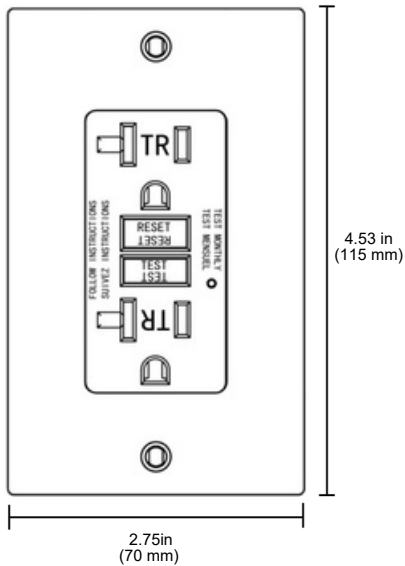

Screwless plate

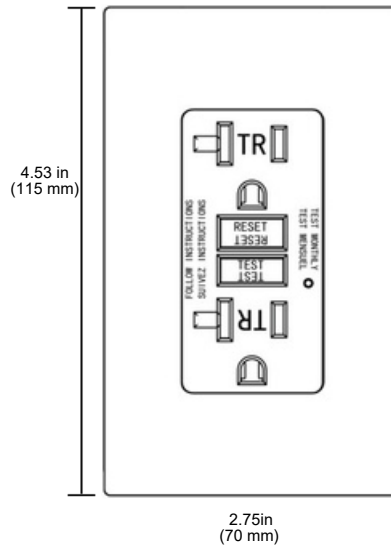

Bulk Unit

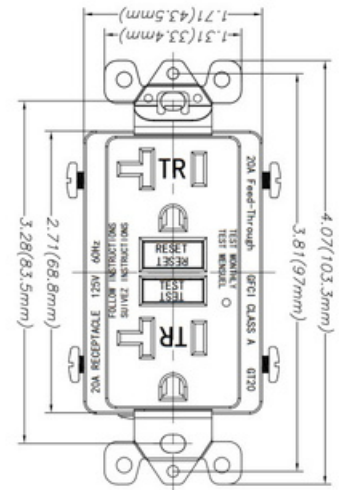

Side View

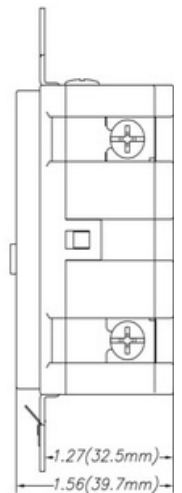

## Installation Steps

### 1. Line

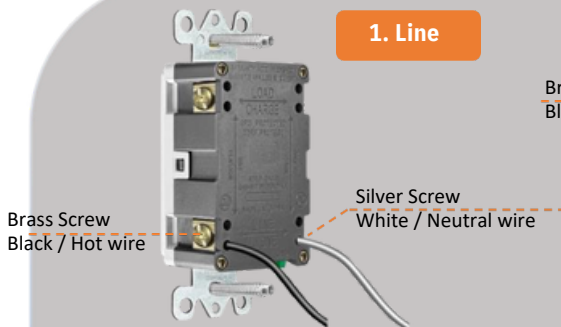

### 2. Load

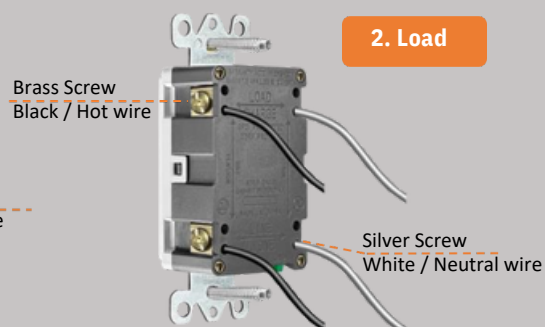

### 3. Grounding

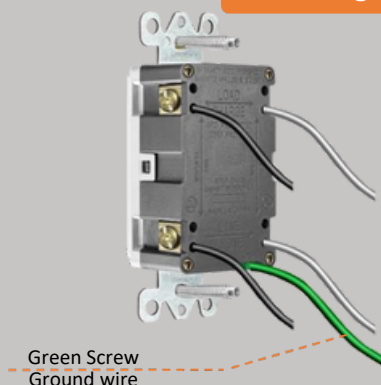

### 4. Reset

Press Reset button after correct installation. The Green Led indicator on GFCI working properly. Test your GFCI monthly to ensure the GFCI continuously provide Ground-fault protection. Cyclic testing every 15 minutes.

