

Catalog Number: **GT20**

Ground Fault Circuit Interrupter Receptacle

20A,125V,60Hz.

Back & Side Wire.

Tamper-Resistant Receptacles.

2-pole,3-wire, NEMA 5-20R,Self-Grounding.



TR

**20A GFCI Outlet
Self-Test**

Color: White WH

General specifications

Product Name	Catalog Number
GFCI Receptacle	GT20
UPC Code	Product Length
8747003240201	1.56 in
Product Height	Product Width
4.07 in	1.71 in
Product Weight	Certifications
127g/0.280 lb	UL/CUL Listed NOM

Material characteristics

- Material: Face, Thermoplastic; Body, Thermoplastic;
- 0.8mm thick high-precision phosphorus bronze;
- 1.2mm thick galvanized steel bracket;
- Silver alloy contacts with 30 silver layer thick;
- Coated PC board with Smart chip MCU to protect critical components from moisture;
- Environmental: Flammability UL-94 V2 Rating.



Production Specifications

Standard Certifications

- Meet UL®943 Class A GFCIs & UL®498 for receptacles;
- Complies to NEC®;
- UL®Listed E504391;
- CSA Certified;
- NOM Certified;
- Self-Test meets UL®943, 5th Ed./Csa 22.2 requirement.

Electrical

- Trip Level: 4~6 mA;
- Trip Time: < 0.25 Seconds;
- Frequency: 60 Hz;
- Max Interruption: 10,000 A;
- Working Voltage: 102V~132V;
- Rating Voltage: 125V

Environmental

- Operating Temperature: -35°C to 66°C(-30°F to 150 °F);
- Maximum Humidity: 95%.

Applications

- Residential:
 - Bathrooms\Kitchens\Basements\Garages\Laundry rooms\Wet locations
- Social institution:
 - School class rooms\Laboratories\Restrooms and Kitchens
 - Airports\Commercial Offices\Shopping centers
 - Restaurants\Hotels\Public bathrooms
 - Public Areas receptacle which near wet or damp locations.

Production Specifications

Default Configuration

- Device Type
Receptacle
- Amperage Rating
20A
- Features
Tamper-Resistant
- Torque Rating
16 lbf-inch
- Type
Self -Test
- Voltage Rating
125V
- Contact Material
Brass
- Number of Wires
Three -wires
- Circuit Interrupter Type
GFCI
- NEMA Configuration
5-20R
- Wiring Method
Back & Side Wire,grounding
- Number of Poles
Two-poles

GFCI Working Status



Green light:
GFCI working properly;
Cyclic testing every 15 minutes.



Red light blinking:
GFCI Self-Testing;
Red light On ALERT !
GFCI reached its service life and needs to be replaced.



Led Off (No power) :
GFCI tripped, press RESET button;
Check the power circuit if can not reset.

Colors:



White
WH



Ivory
IV



Almond
AL



Grey
GR



Black
BK



Brown
BR

Production Specifications

Dimensions

Standard plate

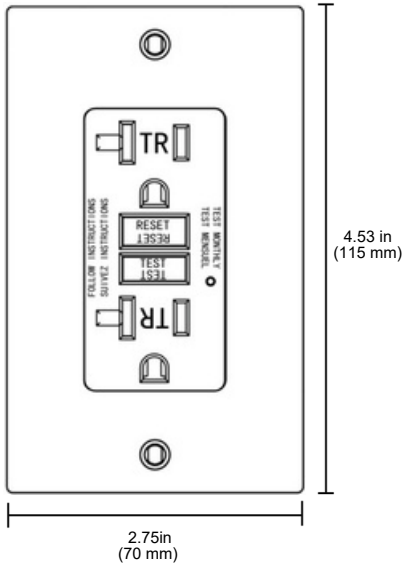

Screwless plate

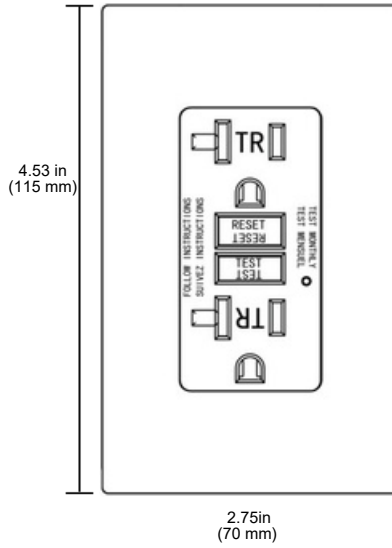

Bulk Unit

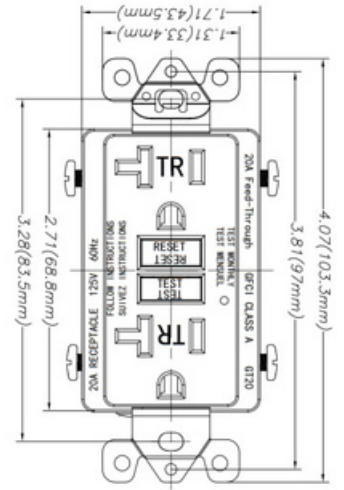

Side View

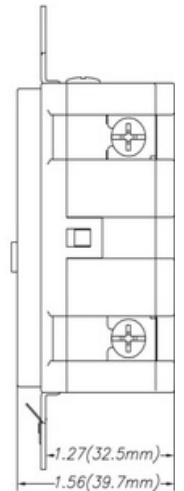

Installation Steps

1. Line

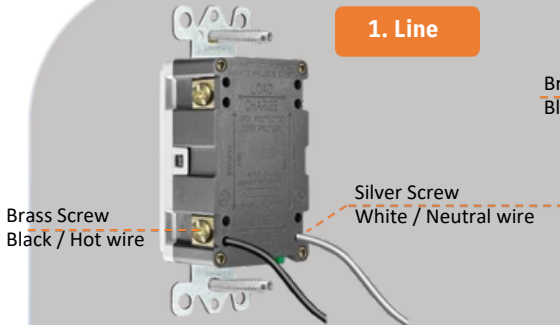

2. Load

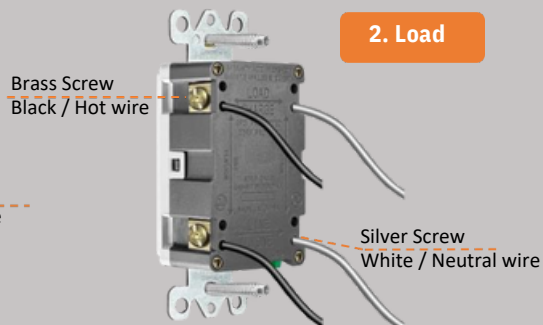

3. Grounding

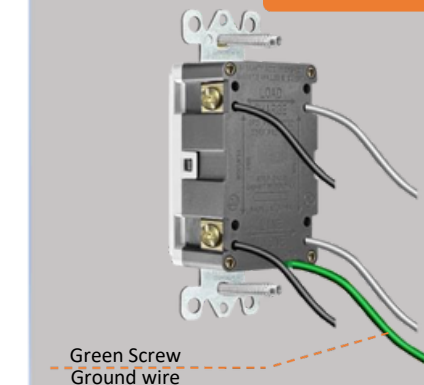

4. Reset

